

**APPLICATION TO INSTALL PRIVATE LINE**

DATE: September 14, 2022

TO THE COMMISSIONERS COURT OF BROWN COUNTY,

Application is hereby made by Unite Private Networks, to install a buried X or aerial    water    telephone X electric    gas    line within the right-of-way and/or across a county road in Brown County, Texas, as follows:

Precinct #   1   Location: CR 267 This will involve a bore X or cut   .

The location and description of the proposed line and associated appurtenances is more fully shown by the plat of such line attached to this application. The line will be constructed and maintained on the County right-of-way in accordance with governing laws. And installed at a depth of 24" to 30" below the lowest level of the bar ditch.

The applicant agrees to remove or relocate such fixtures at his own expense so as to permit the widening or changing of traffic lanes or reconstruction of the roadbed. Such removal or relocation shall be within 30 days of written notice specifying the fixtures to be moved and indicate the place on the roadway to which they shall be replaced.

Notwithstanding any other provision contained herein, it is expressly understood that tender of this notice by the undersigned does constitute a waiver, surrender, abandonment or impairment of any property rights, franchise, easement, license, authority, permission, privilege or right now granted by law or may be granted in the future and any provision of provisions so construed shall be null and void.

The Commissioner of the above precinct will be notified of the time and date of installation at least 24 hours in advance.

This permit will become null and void if work is not completed within 90 days from date of acceptance by the Brown County Commissioners Court.

I certify that the above-proposed installation will not impair or harm the ingress and egress of adjacent landowners.

Construction of this line will begin on or after the 28th day of September, 2022

By Charlene Q. White  
Address 1511 Baltimore Ave, 2nd FL  
Kansas City, MO 64108  
Phone 816-591-5095

September 19, 2022  
(Exhibit #6)

NOTE:  
 ALL AS-BUILTS WILL REQUIRE TEXT AND RED LINES  
 VIA PDF WRITER. NO OTHER FORM WILL BE ACCEPTED

NOTE:  
 CONTRACTOR TO VERIFY  
 EXISTING CUSTOMERS CONDUIT PATH  
 IN TO BUILDING PRIOR CONSTRUCTION

NOTE:  
 CONTRACTOR TO VERIFY  
 EXISTING UTILITY LOCATION  
 PRIOR CONSTRUCTION

NOTE:  
 CONTRACTOR TO VERIFY  
 EXISTING UTILITY LOCATION  
 PRIOR CONSTRUCTION

CALL NUMBER 100 315  
 48 HOUR NOTICE REQUIRED



Know what's below,  
 Call before you dig.

NOTE:  
 UNDERGROUND UTILITIES HAVE BEEN PLOTTED FROM AVAILABLE  
 RECORDS AND FIELD SURVEY. THESE UTILITIES ARE NOT NEARLY EXACT.  
 IT IS THE CONTRACTOR RESPONSIBILITY TO FIELD LOCATE ALL  
 UNDERGROUND OBSTRUCTIONS AND UTILITIES PRIOR TO CONSTRUCTION.  
 COMPLETE REPAIR OF ANY AND ALL DAMAGES INCURRED SHALL BE AT  
 THE EXPENSE OF THE CONTRACTOR.

DESCRIPTION	UNIT	QUANTITY	NOTES
24" FIBER OPTIC CABLE (RIBBED)	LF	11,125.78	SEE FIELD
24" FIBER OPTIC CABLE (SMOOTH)	LF	14,731.42	SEE FIELD
24" FIBER OPTIC CABLE (RIBBED) - 90° BEND	LF	100	SEE FIELD
24" FIBER OPTIC CABLE (SMOOTH) - 90° BEND	LF	100	SEE FIELD
1" COIL (RIBBED)	EA	2	SEE FIELD
1" COIL (SMOOTH)	EA	2	SEE FIELD
2" COIL (RIBBED)	EA	2	SEE FIELD
2" COIL (SMOOTH)	EA	2	SEE FIELD
3" COIL (RIBBED)	EA	2	SEE FIELD
3" COIL (SMOOTH)	EA	2	SEE FIELD
4" COIL (RIBBED)	EA	2	SEE FIELD
4" COIL (SMOOTH)	EA	2	SEE FIELD
5" COIL (RIBBED)	EA	2	SEE FIELD
5" COIL (SMOOTH)	EA	2	SEE FIELD
6" COIL (RIBBED)	EA	2	SEE FIELD
6" COIL (SMOOTH)	EA	2	SEE FIELD
7" COIL (RIBBED)	EA	2	SEE FIELD
7" COIL (SMOOTH)	EA	2	SEE FIELD
8" COIL (RIBBED)	EA	2	SEE FIELD
8" COIL (SMOOTH)	EA	2	SEE FIELD
9" COIL (RIBBED)	EA	2	SEE FIELD
9" COIL (SMOOTH)	EA	2	SEE FIELD
10" COIL (RIBBED)	EA	2	SEE FIELD
10" COIL (SMOOTH)	EA	2	SEE FIELD
12" COIL (RIBBED)	EA	2	SEE FIELD
12" COIL (SMOOTH)	EA	2	SEE FIELD
14" COIL (RIBBED)	EA	2	SEE FIELD
14" COIL (SMOOTH)	EA	2	SEE FIELD
16" COIL (RIBBED)	EA	2	SEE FIELD
16" COIL (SMOOTH)	EA	2	SEE FIELD
18" COIL (RIBBED)	EA	2	SEE FIELD
18" COIL (SMOOTH)	EA	2	SEE FIELD
20" COIL (RIBBED)	EA	2	SEE FIELD
20" COIL (SMOOTH)	EA	2	SEE FIELD

TEP FIBER  
 409 INTERNATIONAL - STE 200  
 RICHARDSON, TX 75081

Unite PRIVATE NETWORKS  
 BROWN COUNTY  
 EARLY, TX

PROJECT: FIBER OPTIC CABLE BUILD  
 CLIENT: EARLY COUNTY  
 ADDRESS: 4800 CO RD 201 EARLY, TX 76802  
 DRAWN BY: JIMMY D. TOWERS/IST/1718 P. 1/DWG  
 DATE: 11/27/18

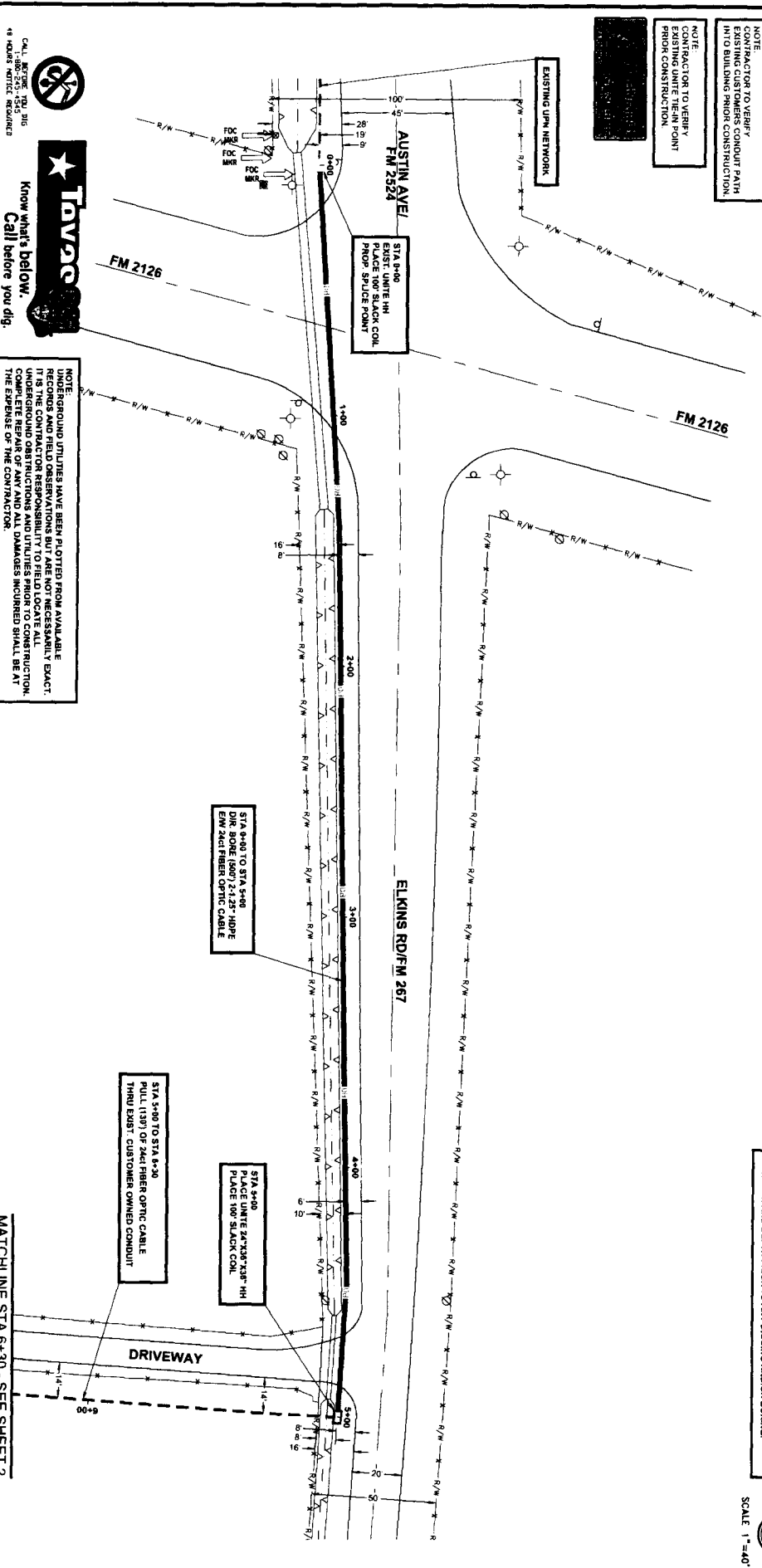

CAUTION III:  
 CONTRACTOR TO LOCATE &  
 VERIFY ALL EXISTING UTILITIES  
 PRIOR TO CONSTRUCTION

CAUTION II:  
 EXIST BURIED FIBER, TELEPHONE, CATV, GAS, ELECTRIC, WATER,  
 SANITARY SEWER & STORM SEWER FACILITIES IN CONSTRUCTION AREA  
 AND HAVE NOT BEEN FIELD LOCATED. CONTRACTOR TO VERIFY EXACT  
 LOCATION AND DEPTH PRIOR TO ANY DIGGING AND/OR BORING.



APPROVAL

Gary Worley  
David [unclear]  
[unclear]  
Larry [unclear]

The Commissioner's Court of Brown County offers no objections to the location on the right-of-way and/or crossing of your proposed buried line as shown by accompanying drawings and notice dated 9-19-22, except as noted below:

It is further intended that the Commissioner's Court may require the owner to relocate This line, subject to provisions of governing laws, by giving thirty (30) days written notice.

The installation shall not damage any part of the county road and adequate provisions must be made to cause a minimum inconvenience to traffic and adjacent property owners.

Please notify Gary Worley, Commissioner of Precinct # 1,

Twenty-four (24) hours prior to starting construction of the line, in order that we may have a representative present.

BROWN COUNTY COMMISSIONERS COURT  
 OF BROWNWOOD, TEXAS

BY: [Signature]  
County Judge

Exceptions and/or special requirements:

**SUBJECT TO BROWN COUNTY SPECIFICATIONS** for boring a road.